

Attachment B6

Architectural Plans – Buildings G&H
--



NAME	DATE	TIME	INSTRUMENT	WAVELONG	WAVELONG ERROR	FLUX	FLUX ERROR	SNR	STATUS
1	2000-01-01	00:00:00	1.0	1.0	0.0	0.0	0.0	0.0	0.0
2	2000-01-01	00:00:00	1.0	1.0	0.0	0.0	0.0	0.0	0.0
3	2000-01-01	00:00:00	1.0	1.0	0.0	0.0	0.0	0.0	0.0
4	2000-01-01	00:00:00	1.0	1.0	0.0	0.0	0.0	0.0	0.0
5	2000-01-01	00:00:00	1.0	1.0	0.0	0.0	0.0	0.0	0.0
6	2000-01-01	00:00:00	1.0	1.0	0.0	0.0	0.0	0.0	0.0
7	2000-01-01	00:00:00	1.0	1.0	0.0	0.0	0.0	0.0	0.0
8	2000-01-01	00:00:00	1.0	1.0	0.0	0.0	0.0	0.0	0.0
9	2000-01-01	00:00:00	1.0	1.0	0.0	0.0	0.0	0.0	0.0
10	2000-01-01	00:00:00	1.0	1.0	0.0	0.0	0.0	0.0	0.0
11	2000-01-01	00:00:00	1.0	1.0	0.0	0.0	0.0	0.0	0.0
12	2000-01-01	00:00:00	1.0	1.0	0.0	0.0	0.0	0.0	0.0
13	2000-01-01	00:00:00	1.0	1.0	0.0	0.0	0.0	0.0	0.0
14	2000-01-01	00:00:00	1.0	1.0	0.0	0.0	0.0	0.0	0.0
15	2000-01-01	00:00:00	1.0	1.0	0.0	0.0	0.0	0.0	0.0
16	2000-01-01	00:00:00	1.0	1.0	0.0	0.0	0.0	0.0	0.0
17	2000-01-01	00:00:00	1.0	1.0	0.0	0.0	0.0	0.0	0.0
18	2000-01-01	00:00:00	1.0	1.0	0.0	0.0	0.0	0.0	0.0
19	2000-01-01	00:00:00	1.0	1.0	0.0	0.0	0.0	0.0	0.0
20	2000-01-01	00:00:00	1.0	1.0	0.0	0.0	0.0	0.0	0.0
21	2000-01-01	00:00:00	1.0	1.0	0.0	0.0	0.0	0.0	0.0
22	2000-01-01	00:00:00	1.0	1.0	0.0	0.0	0.0	0.0	0.0
23	2000-01-01	00:00:00	1.0	1.0	0.0	0.0	0.0	0.0	0.0
24	2000-01-01	00:00:00	1.0	1.0	0.0	0.0	0.0	0.0	0.0
25	2000-01-01	00:00:00	1.0	1.0	0.0	0.0	0.0	0.0	0.0
26	2000-01-01	00:00:00	1.0	1.0	0.0	0.0	0.0	0.0	0.0
27	2000-01-01	00:00:00	1.0	1.0	0.0	0.0	0.0	0.0	0.0
28	2000-01-01	00:00:00	1.0	1.0	0.0	0.0	0.0	0.0	0.0
29	2000-01-01	00:00:00	1.0	1.0	0.0	0.0	0.0	0.0	0.0
30	2000-01-01	00:00:00	1.0	1.0	0.0	0.0	0.0	0.0	0.0
31	2000-01-01	00:00:00	1.0	1.0	0.0	0.0	0.0	0.0	0.0
32	2000-01-01	00:00:00	1.0	1.0	0.0	0.0	0.0	0.0	0.0
33	2000-01-01	00:00:00	1.0	1.0	0.0	0.0	0.0	0.0	0.0
34	2000-01-01	00:00:00	1.0	1.0	0.0	0.0	0.0	0.0	0.0
35	2000-01-01	00:00:00	1.0	1.0	0.0	0.0	0.0	0.0	0.0
36	2000-01-01	00:00:00	1.0	1.0	0.0	0.0	0.0	0.0	0.0
37	2000-01-01	00:00:00	1.0	1.0	0.0	0.0	0.0	0.0	0.0
38	2000-01-01	00:00:00	1.0	1.0	0.0	0.0	0.0	0.0	0.0
39	2000-01-01	00:00:00	1.0	1.0	0.0	0.0	0.0	0.0	0.0
40	2000-01-01	00:00:00	1.0	1.0	0.0	0.0	0.0	0.0	0.0
41	2000-01-01	00:00:00	1.0	1.0	0.0	0.0	0.0	0.0	0.0
42	2000-01-01	00:00:00	1.0	1.0	0.0	0.0	0.0	0.0	0.0
43	2000-01-01	00:00:00	1.0	1.0	0.0	0.0	0.0	0.0	0.0
44	2000-01-01	00:00:00	1.0	1.0	0.0	0.0	0.0	0.0	0.0
45	2000-01-01	00:00:00	1.0	1.0	0.0	0.0	0.0	0.0	0.0
46	2000-01-01	00:00:00	1.0	1.0	0.0	0.0	0.0	0.0	0.0
47	2000-01-01	00:00:00	1.0	1.0	0.0	0.0	0.0	0.0	0.0
48	2000-01-01	00:00:00	1.0	1.0	0.0	0.0	0.0	0.0	0.0
49	2000-01-01	00:00:00	1.0	1.0	0.0	0.0	0.0	0.0	0.0
50	2000-01-01	00:00:00	1.0	1.0	0.0	0.0	0.0	0.0	0.0
51	2000-01-01	00:00:00	1.0	1.0	0.0	0.0	0.0	0.0	0.0
52	2000-01-01	00:00:00	1.0	1.0	0.0	0.0	0.0	0.0	0.0
53	2000-01-01	00:00:00	1.0	1.0	0.0	0.0	0.0	0.0	0.0
54	2000-01-01	00:00:00	1.0	1.0	0.0	0.0	0.0	0.0	0.0
55	2000-01-01	00:00:00	1.0	1.0	0.0	0.0	0.0	0.0	0.0
56	2000-01-01	00:00:00	1.0	1.0	0.0	0.0	0.0	0.0	0.0
57	2000-01-01	00:00:00	1.0	1.0	0.0	0.0	0.0	0.0	0.0
58	2000-01-01	00:00:00	1.0	1.0	0.0	0.0	0.0	0.0	0.0
59	2000-01-01	00:00:00	1.0	1.0	0.0	0.0	0.0	0.0	0.0
60	2000-01-01	00:00:00	1.0	1.0	0.0	0.0	0.0	0.0	0.0
61	2000-01-01	00:00:00	1.0	1.0	0.0	0.0	0.0	0.0	0.0
62	2000-01-01	00:00:00	1.0	1.0	0.0	0.0	0.0	0.0	0.0
63	2000-01-01	00:00:00	1.0	1.0	0.0	0.0	0.0	0.0	0.0
64	2000-01-01	00:00:00	1.0	1.0	0.0	0.0	0.0	0.0	0.0
65	2000-01-01	00:00:00	1.0	1.0	0.0	0.0	0.0	0.0	0.0
66	2000-01-01	00:00:00	1.0	1.0	0.0	0.0	0.0	0.0	0.0
67	2000-01-01	00:00:00	1.0	1.0	0.0	0.0	0.0	0.0	0.0
68	2000-01-01	00:00:00	1.0	1.0	0.0	0.0	0.0	0.0	0.0
69	2000-01-01	00:00:00	1.0	1.0	0.0	0.0	0.0	0.0	0.0
70	2000-01-01	00:00:00	1.0	1.0	0.0	0.0	0.0	0.0	0.0
71	2000-01-01	00:00:00	1.0	1.0	0.0	0.0	0.0	0.0	0.0
72	2000-01-01	00:00:00	1.0	1.0	0.0	0.0	0.0	0.0	0.0
73	2000-01-01	00:00:00	1.0	1.0	0.0	0.0	0.0	0.0	0.0
74	2000-01-01	00:00:00	1.0	1.0	0.0	0.0	0.0	0.0	0.0
75	2000-01-01	00:00:00	1.0	1.0	0.0	0.0	0.0	0.0	0.0
76	2000-01-01	00:00:00	1.0	1.0	0.0	0.0	0.0	0.0	0.0
77	2000-01-01	00:00:00	1.0	1.0	0.0	0.0	0.0	0.0	0.0
78	2000-01-01	00:00:00	1.0	1.0	0.0	0.0	0.0	0.0	0.0
79	2000-01-01	00:00:00	1.0	1.0	0.0	0.0	0.0	0.0	0.0
80	2000-01-01	00:00:00	1.0	1.0	0.0	0.0	0.0	0.0	0.0
81	2000-01-01	00:00:00	1.0	1.0	0.0	0.0	0.0	0.0	0.0
82	2000-01-01	00:00:00	1.0	1.0	0.0	0.0	0.0	0.0	0.0
83	2000-01-01	00:00:00	1.0	1.0	0.0	0.0	0.0	0.0	0.0
84	2000-01-01	00:00:00	1.0	1.0	0.0	0.0	0.0	0.0	0.0
85	2000-01-01	00:00:00	1.0	1.0	0.0	0.0	0.0	0.0	0.0
86	2000-01-01	00:00:00	1.0	1.0	0.0	0.0	0.0	0.0	0.0
87	2000-01-01	00:00:00	1.0	1.0	0.0	0.0	0.0	0.0	0.0
88	2000-01-01	00:00:00	1.0	1.0	0.0	0.0	0.0	0.0	0.0
89	2000-01-01	00:00:00	1.0	1.0	0.0	0.0	0.0	0.0	0.0
90	2000-01-01	00:00:00	1.0	1.0	0.0	0.0	0.0	0.0	0.0
91	2000-01-01	00:00:00	1.0	1.0	0.0	0.0	0.0	0.0	0.0
92	2000-01-01	00:00:00	1.0	1.0	0.0	0.0	0.0	0.0	0.0
93	2000-01-01	00:00:00	1.0	1.0	0.0	0.0	0.0	0.0	0.0
94	2000-01-01	00:00:00	1.0	1.0	0.0	0.0	0.0	0.0	0.0
95	2000-01-01	00:00:00	1.0	1.0	0.0	0.0	0.0	0.0	0.0
96	2000-01-01	00:00:00	1.0	1.0	0.0	0.0	0.0	0.0	0.0
97	2000-01-01	00:00:00	1.0	1.0	0.0	0.0	0.0	0.0	0.0
98	2000-01-01	00:00:00	1.0	1.0	0.0	0.0	0.0	0.0	0.0
99	2000-01-01	00:00:00	1.0	1.0	0.0	0.0	0.0	0.0	0.0
100	2000-01-01	00:00:00	1.0	1.0	0.0	0.0	0.0	0.0	0.0

1547	FORMULA NAME	1548	PROJECT
PR	FORMULA NAME	1549	PROJECT
	UNIBO		
	NEURON ENGINEERING		
	FORMULA NAME		
	ABC CONSULTING		
	FORMULA NAME		
	SCIENTIFIC FINE		

NAME	NAME NUMBER	SCORE
A - OVERALL - LEVEL 05		
R-00-10B-05-01		21

[illegible]

227	CONELMINT
FR	PIETRO D'AMICO
US83	
CONELMINT	NEURON ENGINEERING
CONELMINT	APC CONSULTANTS
CONELMINT	
SCIENTIFIC FIRE	

ASIMMO
103 MI
BENT PROXCE
2316013

CORONATION PROPERTY

CORONATION
CROWN

1.111

PA.5207

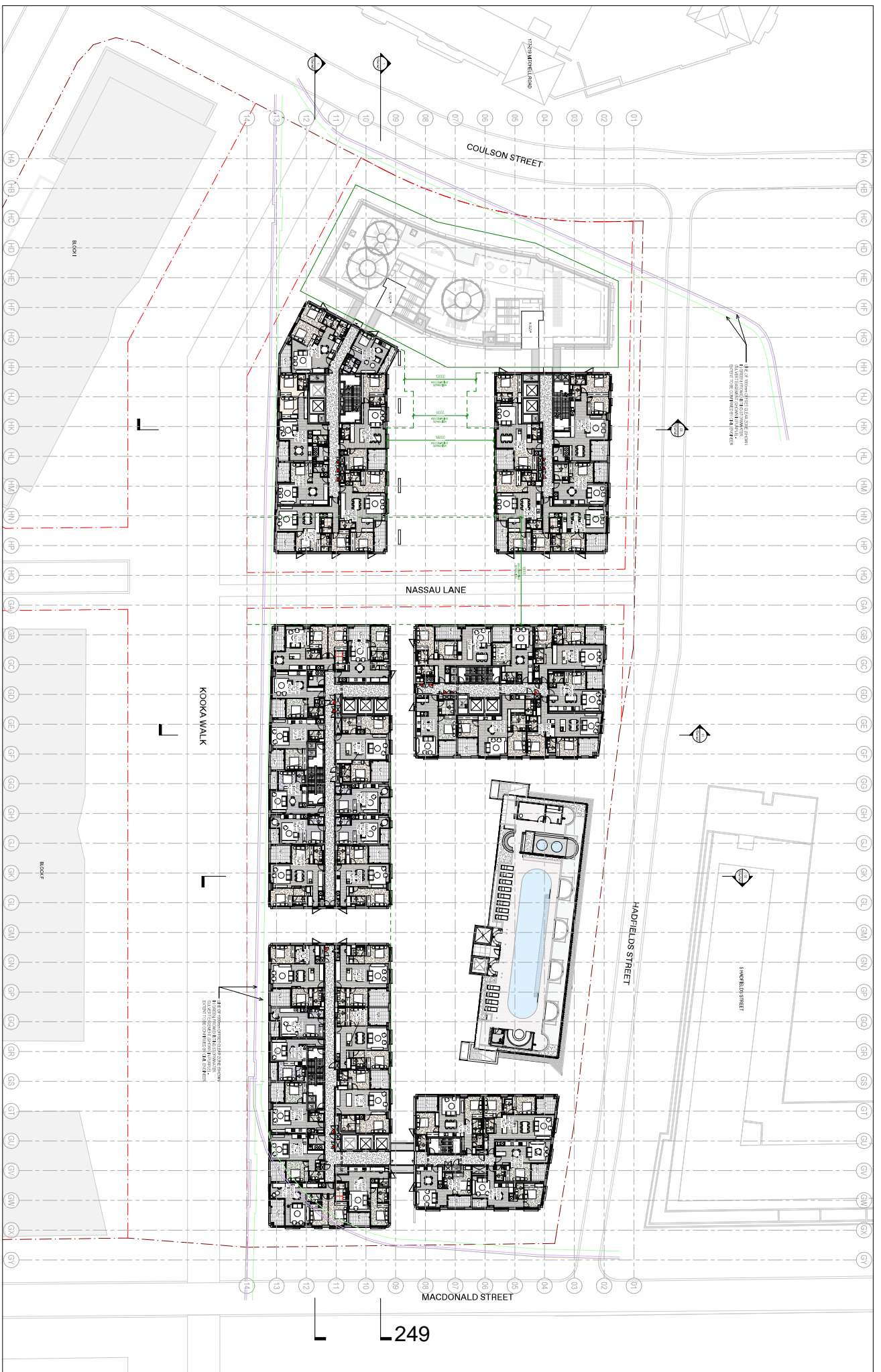
[illegible]

[illegible][illegible][illegible]

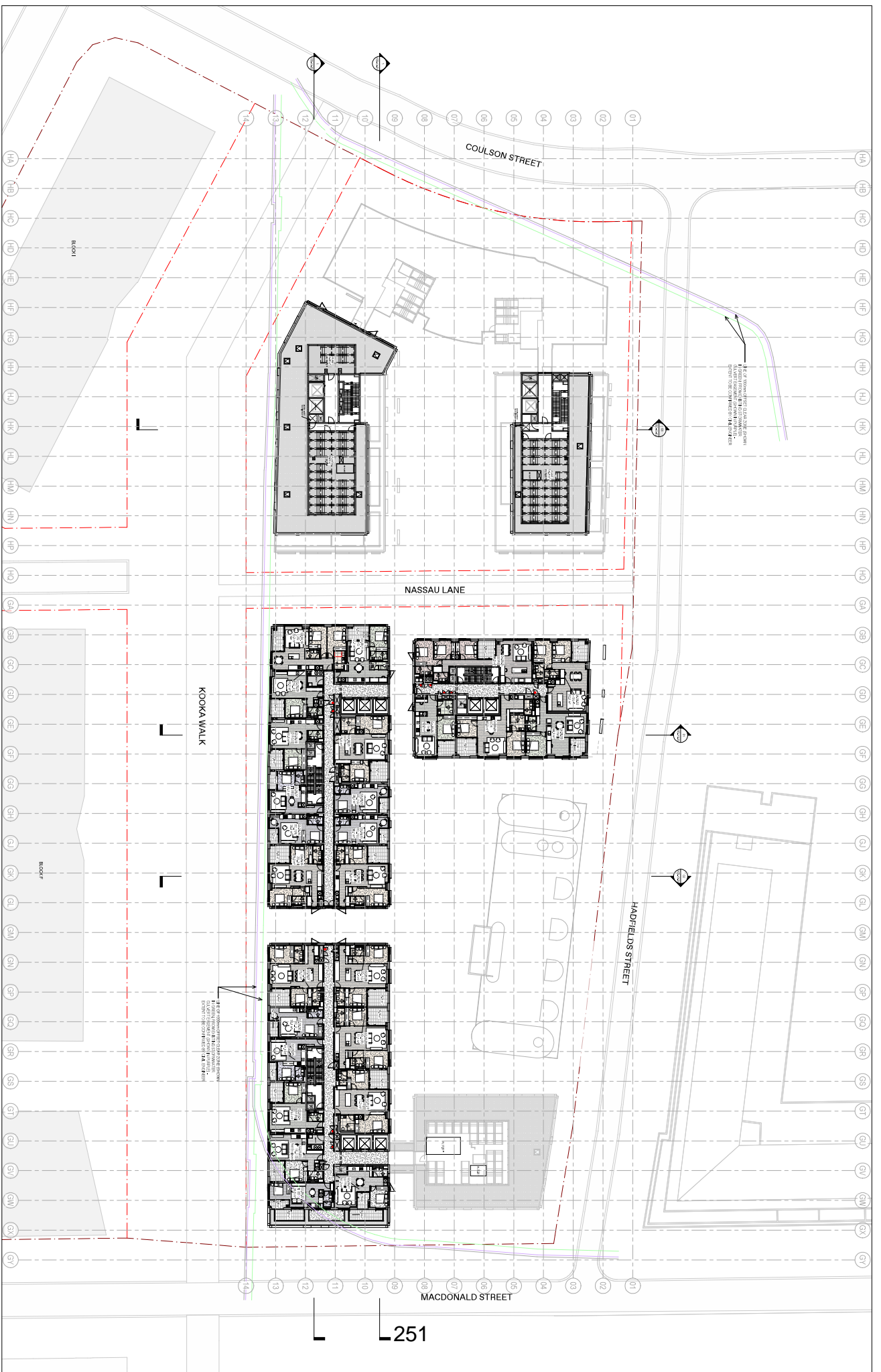

Task	Goal	Task	Goal
1	20.000000	101	0.000000
2	0.000000	102	0.000000
3	0.000000	103	0.000000
4	0.000000	104	0.000000
5	0.000000	105	0.000000
6	0.000000	106	0.000000
7	0.000000	107	0.000000
8	0.000000	108	0.000000
9	0.000000	109	0.000000
10	0.000000	110	0.000000
11	0.000000	111	0.000000
12	0.000000	112	0.000000
13	0.000000	113	0.000000
14	0.000000	114	0.000000
15	0.000000	115	0.000000
16	0.000000	116	0.000000
17	0.000000	117	0.000000
18	0.000000	118	0.000000
19	0.000000	119	0.000000
20	0.000000	120	0.000000
21	0.000000	121	0.000000
22	0.000000	122	0.000000
23	0.000000	123	0.000000
24	0.000000	124	0.000000
25	0.000000	125	0.000000
26	0.000000	126	0.000000
27	0.000000	127	0.000000
28	0.000000	128	0.000000
29	0.000000	129	0.000000
30	0.000000	130	0.000000
31	0.000000	131	0.000000
32	0.000000	132	0.000000
33	0.000000	133	0.000000
34	0.000000	134	0.000000
35	0.000000	135	0.000000
36	0.000000	136	0.000000
37	0.000000	137	0.000000
38	0.000000	138	0.000000
39	0.000000	139	0.000000
40	0.000000	140	0.000000
41	0.000000	141	0.000000
42	0.000000	142	0.000000
43	0.000000	143	0.000000
44	0.000000	144	0.000000
45	0.000000	145	0.000000
46	0.000000	146	0.000000
47	0.000000	147	0.000000
48	0.000000	148	0.000000
49	0.000000	149	0.000000
50	0.000000	150	0.000000
51	0.000000	151	0.000000
52	0.000000	152	0.000000
53	0.000000	153	0.000000
54	0.000000	154	0.000000
55	0.000000	155	0.000000
56	0.000000	156	0.000000
57	0.000000	157	0.000000
58	0.000000	158	0.000000
59	0.000000	159	0.000000
60	0.000000	160	0.000000
61	0.000000	161	0.000000
62	0.000000	162	0.000000
63	0.000000	163	0.000000
64	0.000000	164	0.000000
65	0.000000	165	0.000000
66	0.000000	166	0.000000
67	0.000000	167	0.000000
68	0.000000	168	0.000000
69	0.000000	169	0.000000
70	0.000000	170	0.000000
71	0.000000	171	0.000000
72	0.000000	172	0.000000
73	0.000000	173	0.000000
74	0.000000	174	0.000000
75	0.000000	175	0.000000
76	0.000000	176	0.000000
77	0.000000	177	0.000000
78	0.000000	178	0.000000

